

PART NO.	DIM. "A" ±.015(0.4)
CHDLCBST-2-01	1/8 (3.18)
CHDLCBST-3-01	3/16 (4.76)
CHDLCBST-4-01	1/4 (6.35)
CHDLCBST-5-01	5/16 (7.94)
CHDLCBST-6-01	3/8 (9.53)
CHDLCBST-7-01	7/16 (11.11)
CHDLCBST-8-01	1/2 (12.70)
CHDLCBST-9-01	9/16 (14.29)
CHDLCBST-10-01	5/8 (15.88)

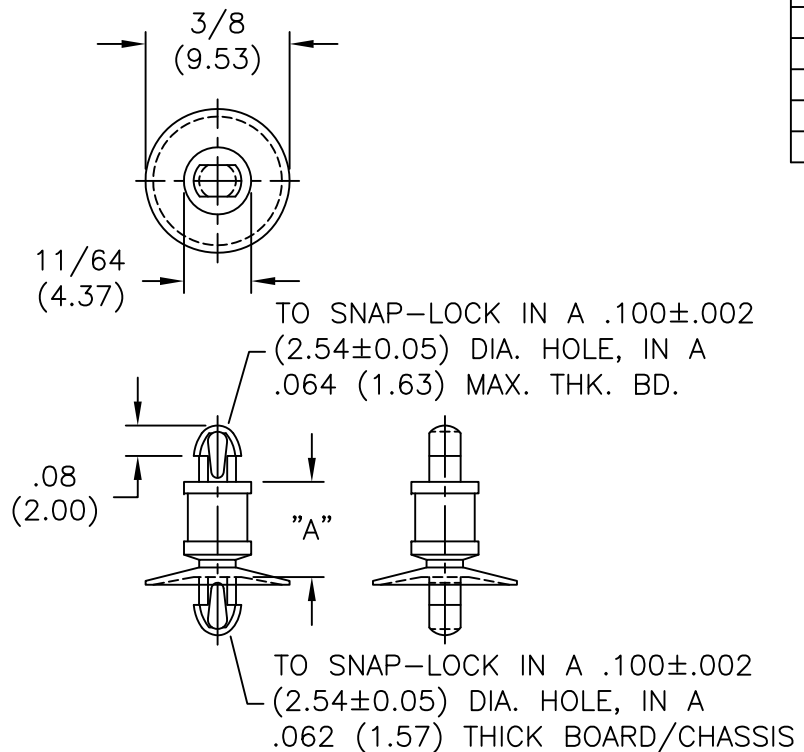

NOTES:

- MATERIAL: NYLON 6/6 UL94 V-2 (RMS-01).
NYLON 6/6 UL94 V-0 (RMS-19) AVAILABLE.
- COLOR: NATURAL.

TITLE: CUPPED HALF DUAL LOCKING CBS, TEARDROP					DWG IN IN (MM)			
D	SEE CO 200647 FOR CHANGES	SK 03.29.11	TOLERANCES UNLESS NOTED	FILE # CHDLCBST	DWN: P.B.	APP:	PART # SEE TABLE	PRINT TYPE CA
C	CHANGED FILE NO. AND TITLE BLOCK	SM 04.27.01	.XX=±.010	MAT'L: SEE NOTES	DT: 06-21-94	DT:		
B	MAT'L RMS-19 ADDED	J.L. 12.19.97	.XXX=±.005	RE: RICHCO, INC.	RICHCO INC. PO BOX 804238, CHICAGO, 60680 (773) 539-4060			
A	CONVERTED TO ACAD	PB 06.21.95	FRAC=±1/64					
REV	DESCRIPTION	ENGR DATE	ANG=±1°					